

RESTORATION NOTES

1. UPON COMPLETION OF WATER MAIN CONSTRUCTION AND REMOVAL OF EXCAVATION SUPPORT EQUIPMENT, THE CONSTRUCTION AREAS WILL BE FULLY RESTORED.
2. ANY RUTTING IN STAGING AREAS SHALL BE RE-GRADED AND EXISTING GRADES RESTORED.
3. LOAM SHALL BE PLACED AS NEEDED TO ENSURE GRASS ESTABLISHMENT.
4. UNLESS OTHER PLANTINGS ARE INDICATED, AREAS IMPACTED BY CONSTRUCTION SHALL BE SEEDED WITH GRASS IN ACCORDANCE WITH SPECIFICATION 02485.

PLANTING SCHEDULE

KEY	QTY	SCIENTIFIC NAME COMMON NAME	SIZE	SPACING
VC	12	VACCINIUM CORYMBOSUM (NORTHLAND) BLUEBERRY	3-4 FT	8' O.C.
AR	6	AMELANCHIER SPP SERVICEBERRY	3-4 FT	APPROX. 20' O.C.
SP	5	PRUNUS MARITIMA BEACH PLUM	3-4 FT	APPROX. 16' O.C.
JH	48	JUNIPERUS HORIZONTALIS JUNIPER	3 GAL	APPROX. 5' O.C.

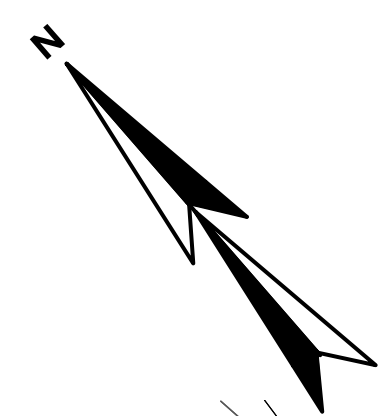
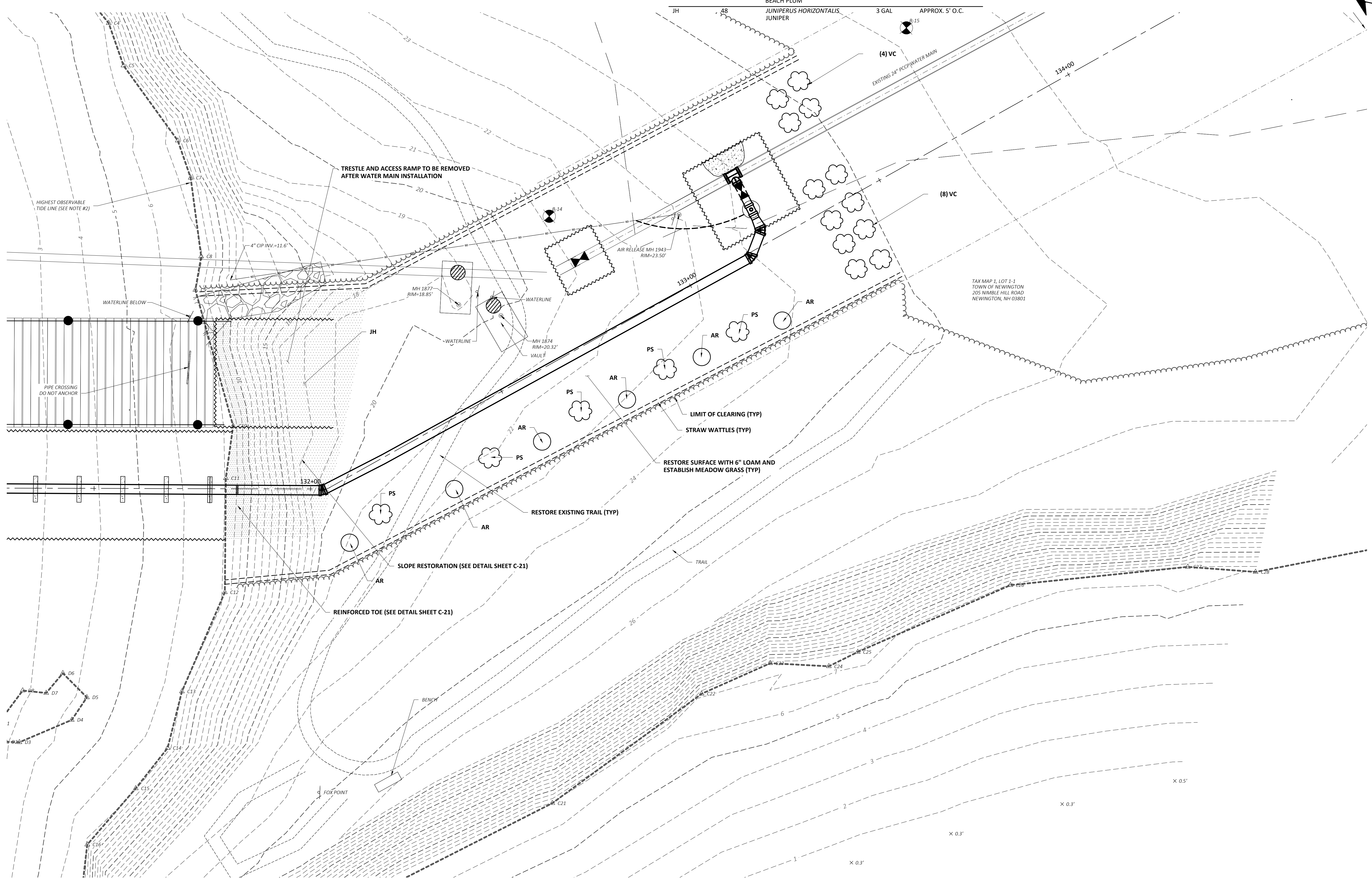

PLAN
SCALE: 1"=10'

NO	DATE	APPROVED
SUBMISSIONS/REVISIONS		
DESIGNED BY: D.LARY CAD CORP: W.EDGAR CHECKED BY: W.EDGAR DATE: APPROVED BY: DATE: PROJECT NO: 14202A		
WRIGHT-PIERCE Engineering a Better Environment 888.621.8156 www.wright-pierce.com		
CITY OF PORTSMOUTH SUBAQUEOUS WATER TRANSMISSION MAIN LITTLE BAY, DURHAM-NEWINGTON NEW HAMPSHIRE		
RESTORATION PLAN - NEWINGTON		
DRAWING		
C-17		